

## Double-face holding type Electro-Permanent Magnetic Block

### KEPB-2F

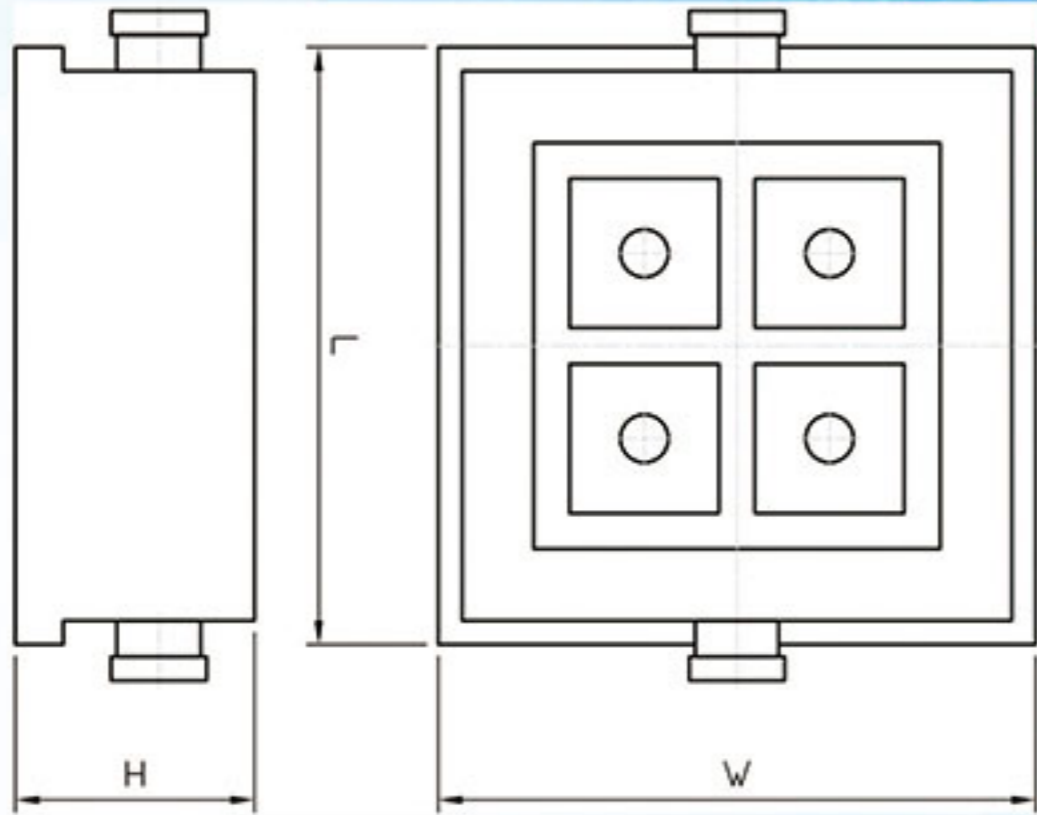

▲ 尺寸圖 Size Chart

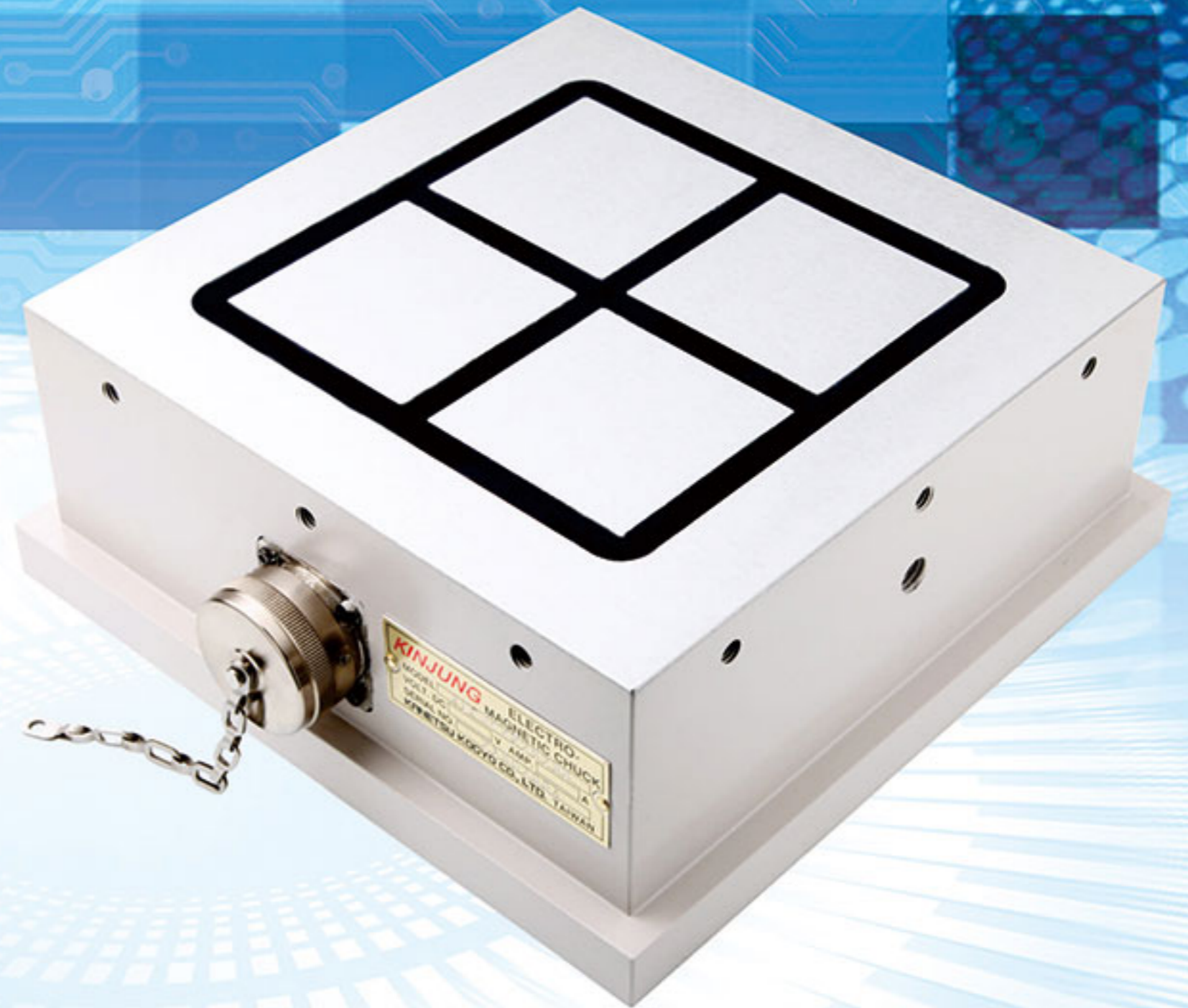

#### 用途

專為在磨床機台上吸著工件使用。

#### 特性

- 藉由確保固定工件垂懸，可縮短2面加工中心的設定時間，而且可輕易移動位置。
- 這些磁塊可用於濕式操作，因此可以如同一般的磁性夾盤來使用。
- 由於永電式特性，吸力不受斷電或電線故障影響，而且因為只有非常小的熱量產生，因此，工件受熱的影響是最小的。
- 電源線的金屬接頭可輕易分離，可因應托盤改變或做外部設置。
- 可2面同時吸著。

#### Application

These blocks are designed for holding work pieces on grinding machine.

#### Features

- By securing a work piece overhanging, the 2-face machining center setup time can be shortened, and move place easily.
- These blocks can be used in wet operations and therefore can be used like normal magnetic chucks.
- Since these blocks are of electro-permanent type, the holding power is not affected by power failure or cable breakage.
- Also since very little heat is generated, thermal influence on work piece is minimal.
- The metal connecting joint facilitates disconnection of the power cable. (Pallet change and external setup supported.)
- 2 faces can hold work pieces at the same time.

#### 規格表 Specification Table

型式 Model	尺寸 Dimension			磁極尺寸 Pole size	磁極數 No. of poles	電壓 Voltage	重量 Weight
	L	W	H				
KEPB-2F1625B	160	250	100	70	2	DC220V	23Kg
KEPB-2F2525B	250	250	100	70	4	DC220V	35Kg
KEPB-2F3333B	330	330	100	70	9	DC220V	61Kg

mm

※永電式夾盤的開關操作應當一次暫停數分鐘，若經常重複開關可能會導致過熱損壞

On/off operation of this EP chuck should be made once in several minutes pauses. If power on/off is repeated frequently, it can cause damage by overheat.

※吸著力在SS400，厚度50mm，表面完全吸著

The holding power applies to SS400, 50mm thick, ground surface held on whole face.

※鐘通工業股份有限公司保有隨技術發展而衍生修改的權利

KANETSU KOGYO CO., LTD. Reserve the right to bring up any modification connected with the technological development.

